

## TERMINALS AND POSITION

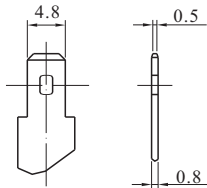

T1

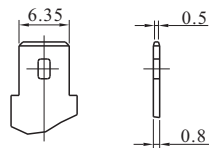

T2

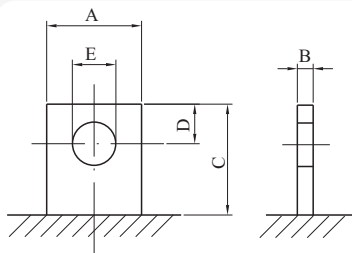

T3 T4 T5 T6 T7 T16 T17 T18 T19 T20

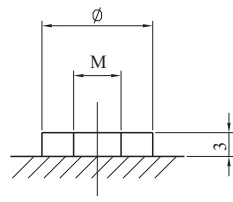

T8 T9 T10 T11 T12 T13 T14 T15

Type	A	B	C	D	E	Material
T3	12	2.0	14	5.0	5.5	Cu
T4	20	3.0	16	7.0	6.0	Cu
T5	22	3.5	22	8.5	8.0	Cu
T6	17	9.0	18	8.0	6.0	Pb
T7	17	6.0	16	7.0	8.0	Pb
T16	20	3.0	18	7.5	8.0	Cu
T17	18	7.0	20	7.5	7.0	Pb
T18	23	7.0	19	8.5	7.0	Pb
T19	25	7.0	24	10.5	9.0	Pb
T20	27	8.0	29	12.0	9.0	Pb

Type	M	Ø	Material
T8	5	12	Cu
T9	6	14	Cu
T10	8	20	Cu
T11	8	16	Cu
T12	8	14	Cu
T13	10	20	Cu
T14	8	18	Cu
T15	6	16	Cu

### Motor Cycle Battery Terminal

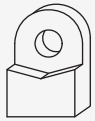

1

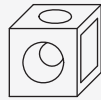

2

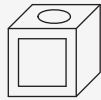

3

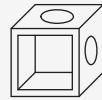

4

### Terminal Position

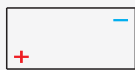

A

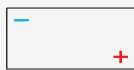

B

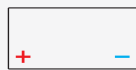

C

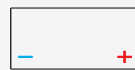

D



E

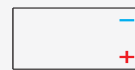

F



G

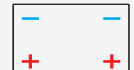

H



I



J



K

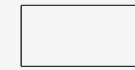

L

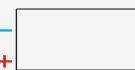

M



N

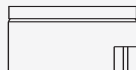

O

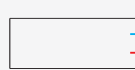

P

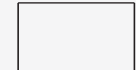

Q



R